

3

2

1

TOP VIEW

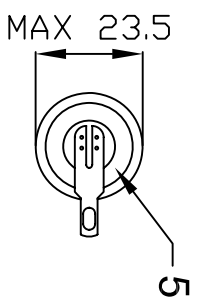

INTRALINK RELEASE LEVEL
MASS PRODUCTION
 THIRD ANGLE PROJECTION

C

SIDE VIEW

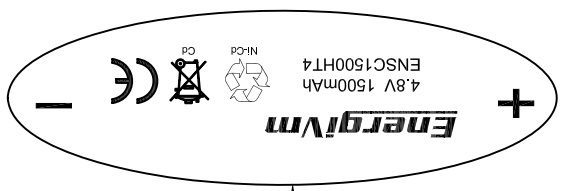
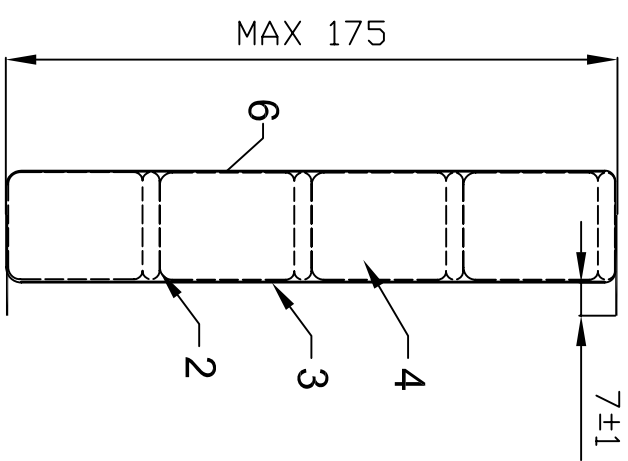

RIGHT VIEW

BOTTOM VIEW

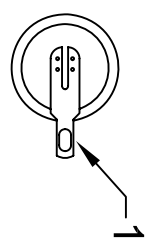

A

INCREASED PRINTING CONTENT

A2	FIRST RELEASE	18-12-10
A1	CHANGE DETAIL	18-11-10
REV		DATE

CAT: HIGH TEMP NICD RECHARGEABLE

DWG NO.: BZ-0759

PART NO.: SC1500HT-S4S

PAGE 1 OF 1

SIGNATURES DATE

DRAWN BY:	ALAN FENG	18-12-10
CHECKED BY:	RITA LUI	18-12-10
APPROVED BY:	SIMON TANG	18-12-10

REF	DESCRIPTION	QTY	REMARKS
6	PAPER CYLINDER	1	SCX4
5	SINGLE CELL INSULATION PLATE	4	WHITE
4	SINGLE CELL	4	SC1500HT
3	BATTERY PACK PVC	1	WHITE
2	CONNECTION TAB	3	
1	OUTPUT TERMINAL	2	YCP-042

NOTE:
 1. NOT TO SCALE
 2. ALL DIMENSIONS IN MM
 3. ALL TOLERANCES ARE +/- 0.5MM UNLESS OTHERWISE SPECIFIED

This document contains Great Energy proprietary data, and is not to be copied, reproduced, used or divulged to unauthorized persons, in whole or in part, without proper authorization in writing from Great Energy. This information is the property of Great Energy which reserves all rights to it.

B

B

3

2

1

A