

Energivm

CE  MH 28269

MVH1290(12V9.0AH)

PHYSICAL SPECIFICATION

Nominal Voltage		12V
Nominal Capacity (20HR)		9Ah
Dimension	Length	151 1mm (5.94 inches)
	Width	65 1mm (2.56 inches)
	Container Height	95 1mm (3.74 inches)
	Total Height	101 1mm (3.98 inches)
Weight		Approx. 2.55 Kg (5.62lbs)
Standard Terminal		Fasten Tab No.250E

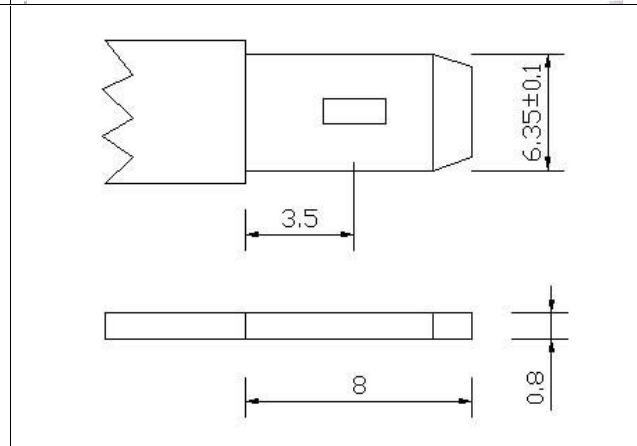
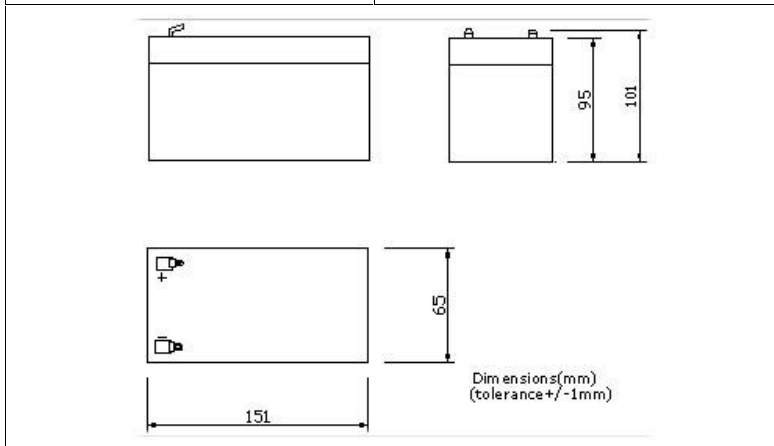

ELECTRICAL SPECIFICATION

Characteristics		Discharge curves @ 25 (77 ° F)	
Capacity	20 hour rate (0.45A) 9Ah 10 hour rate (0.81A) 8.5Ah 5 hour rate (1.53A) 7.7Ah 3 hour rate (2.25A) 6.8Ah 1hour rate (5.4A) 5.4Ah		
Capacity affected by temperature	40 (104 °F) 102% 25 (77 °F) 100% 0 (32 °F) 85%		
Internal Resistance	Full charged battery (25 ,77 °F) 20m		
Constant Voltage Charge	Cycle	Initial Charging Current less than 2.7A Voltage 14.4~15.0V at 25 (77 °F) Temperature Coefficient -30mV/	
	Standby	No limit on Initial Charging Current Voltage 13.5~13.8V at 25 (77 °F) Temperature Coefficient -20mV/	

